

**Grid North**  
Maine Coordinate System of 1983, East Zone

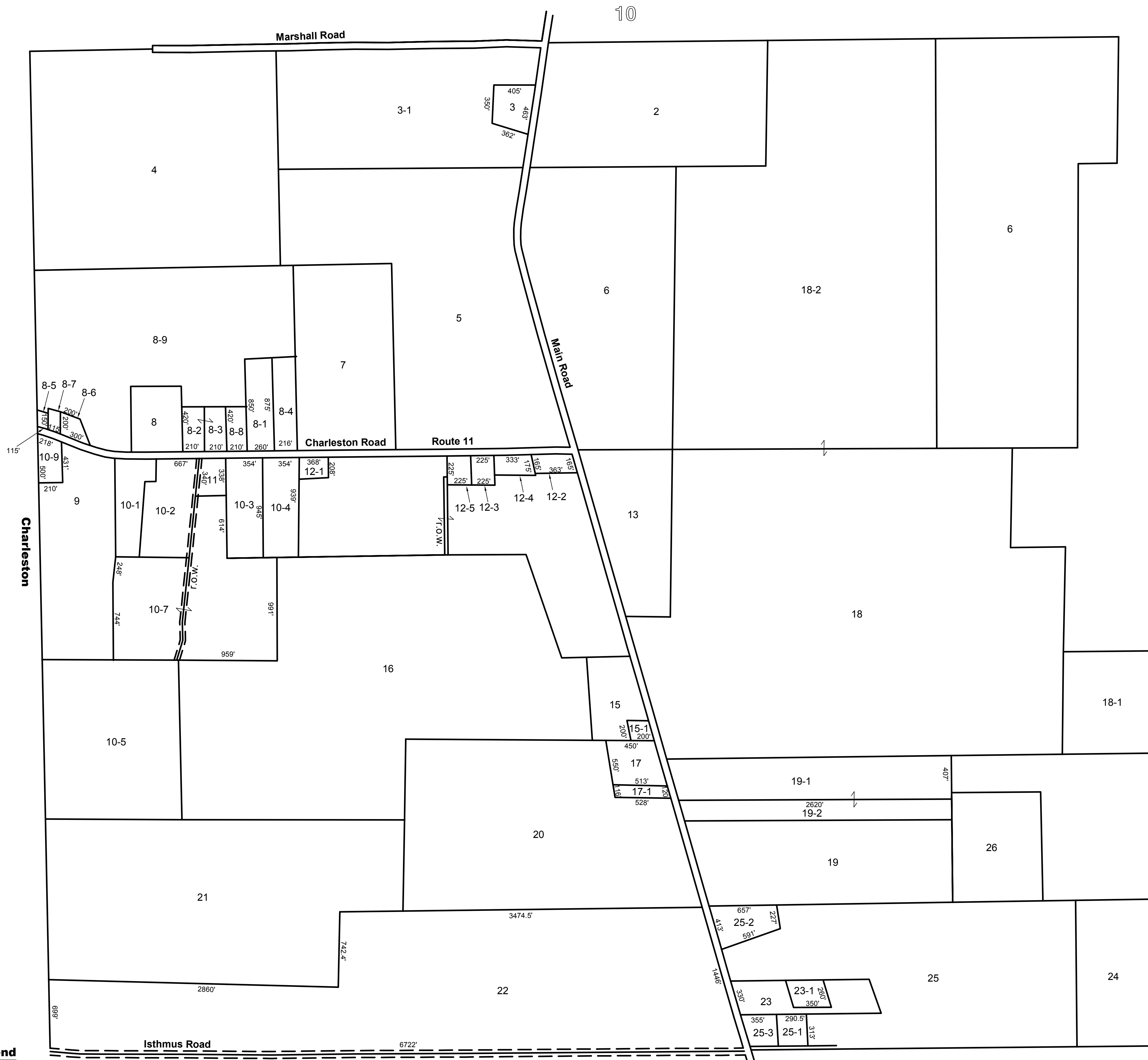

| Revised by          | Year      |
|---------------------|-----------|
| DLM CMA             | 1988-1991 |
| H.R. Dickey         | 1993      |
| H.R. Dickey         | 2002      |
| James W. Sewall Co. | 2003      |
| James W. Sewall Co. | 2005      |
| James W. Sewall Co. | 2007      |
| Plisga & Day        | 2015      |

**PLISGA & DAY  
LAND SURVEYORS**

72 MAIN STREET  
BANGOR, MAINE  
DATE: March 16, 2015  
PROJ. NO. 15009

Email: info@Wemaplt.com  
Phone: (207) 947-0019  
Toll-Free: 1-800-734-0019

DRAWING FILE: 15009.dwg  
[www.Wemaplt.com](http://www.Wemaplt.com)

**Legend**

Parcel numbers 4

Adjacent Maps 4

Stream / Brook - - - - -

**NOTE**

This map is for assessment purposes,  
not to be used for conveyances.

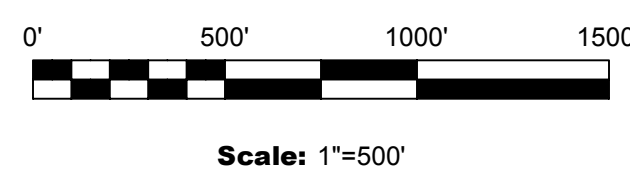

**Property Map  
Town of Bradford  
Penobscot County, Maine**

prepared by  
James W. Sewall Company, Old Town, Maine  
revised by  
Plisga & Day Land Surveyors  
March 16, 2015  
Scale 1 inch = 500 feet  
**Tax Map 7**