

Grid North
Maine Coordinate System of 1983, East Zone

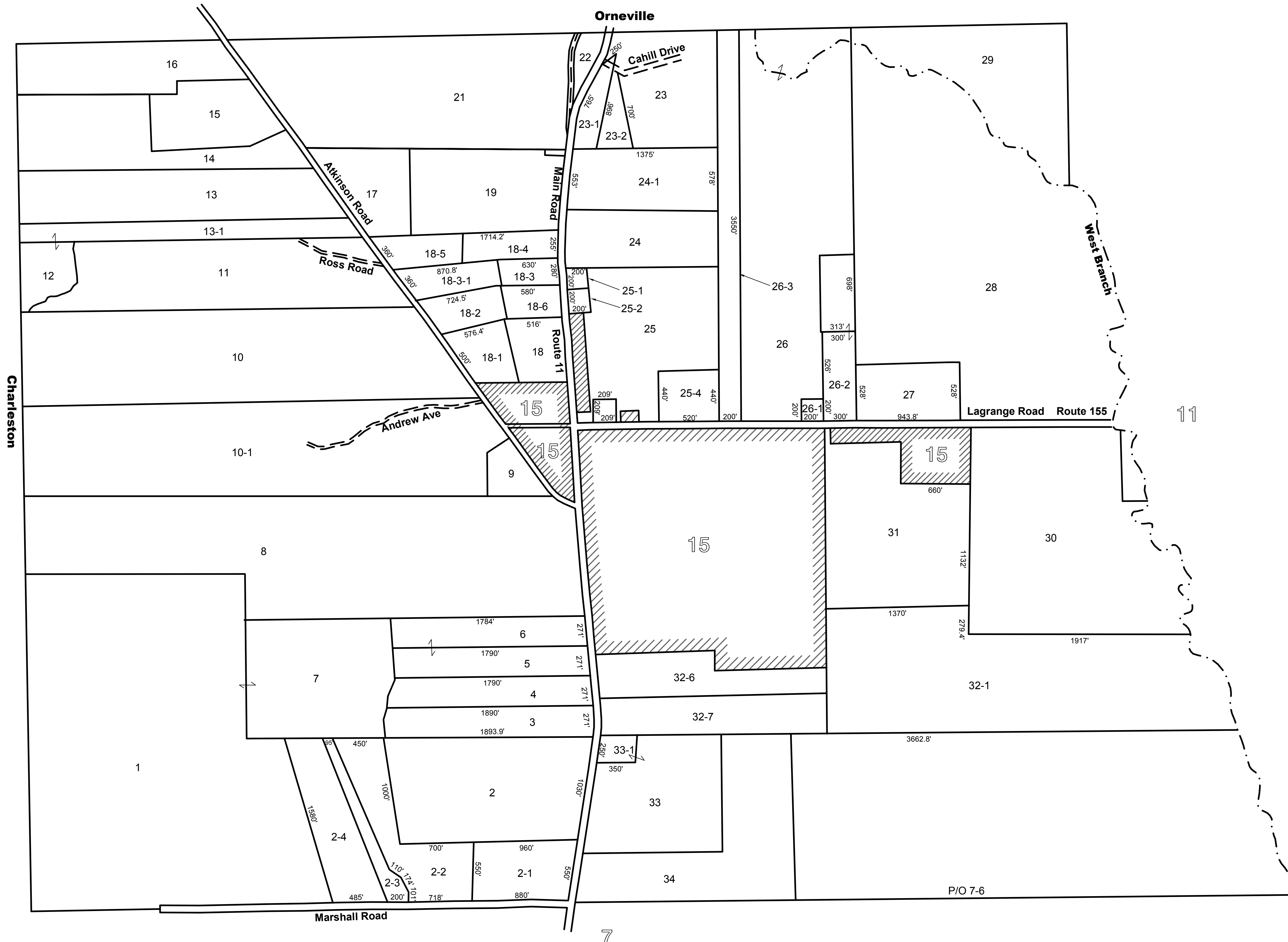

Revised by	Year
D. L. Miles CMA	1988-1990
H.R. Dickey	1993
H.R. Dickey	2002
James W. Sewall Co.	2003
James W. Sewall Co.	2005
James W. Sewall Co.	2007
Plisga & Day	2015

PLISGA & DAY
LAND SURVEYORS
72 MAIN STREET
BANGOR, MAINE
DATE: March 16, 2015
PROJ. NO. 15009
Email: info@WeMapIt.com
Phone: (207) 947-0019
Toll-Free: 1-800-734-0019
DRAWING FILE: 15008.dwg
www.WeMapIt.com

Legend

Parcel numbers 4

Adjacent Maps 4

Stream / Brook - - - - -

NOTE

This map is for assessment purposes,
not to be used for conveyances.

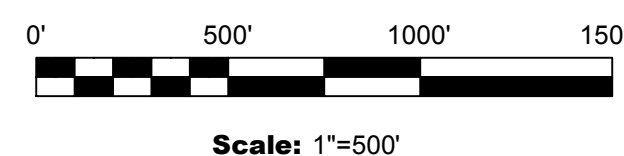

Property Map
Town of Bradford
Penobscot County, Maine

prepared by
James W. Sewall Company, Old Town, Maine
revised by
Plisga & Day Land Surveyors
March 16, 2015
Scale 1 inch = 500 feet
Tax Map 10